

data sheet

Colenta[®]

FILM Processor **20 C41 20 Wash Eco**



Colenta[®]

C41 Processor options for sheet and roll film
up to 20cm in width

09/2016 AN



C41 Film Processor

TYPE: COLENTA 20 C41 20 Wash Eco

Technical Specifications:

Processing applications:	C41 Negative film
Max. Process width:	max. 20 cm - 8 inch (3 Track loading of 35mm film)
Microprocessor Control:	with 4 preprogrammable processing cycles
Processing capacity:	20cm per minute @ 3min 15sec Dev.Time (Dev. times are pre-programmable)

Tank capacities: 20 C41 20 Wash Eco

Developer	:	7,5
Bleach	:	10,5
Wash	:	5,5
Fix	:	10,5
Wash	:	7,5
STAB	:	5,5



**Microprocessor
controlled Display**

Replenishment:	<ul style="list-style-type: none">- Precisely controlled using opto-sensors to measure the film area loading.- Activated after a pre-programmed film area is fed into the processor- Antioxidation/standby replenishment, activated after 0-9 hours *
Solution Levels:	<ul style="list-style-type: none">Low Level monitoring in all tanksHigh Level monitoring in Overflow Collection Tanks (waste management, optional) *Low Level in Repl. Tanks for Dev-, Bleach, Fix and Stabi (optional) *
Temperatures:	High / Low level monitoring for all the wet-tanks incl cold water cooling
Work in Progress :	Details the location of film within the processor.
Transport:	Drive motor overload monitoring Security cover lid switch
standard accessories:	<ul style="list-style-type: none">- rack carrier drip tray- basic installation kit- 3 x 35mm film loading assy- small spare part kit
optional accessories:	<ul style="list-style-type: none">- day light loading sleeves in loading box- external chiller unit- roll feed up and motorized take up device

Technical specification subject to change without notice.

Transport System: 20 C41 20 Wash Eco

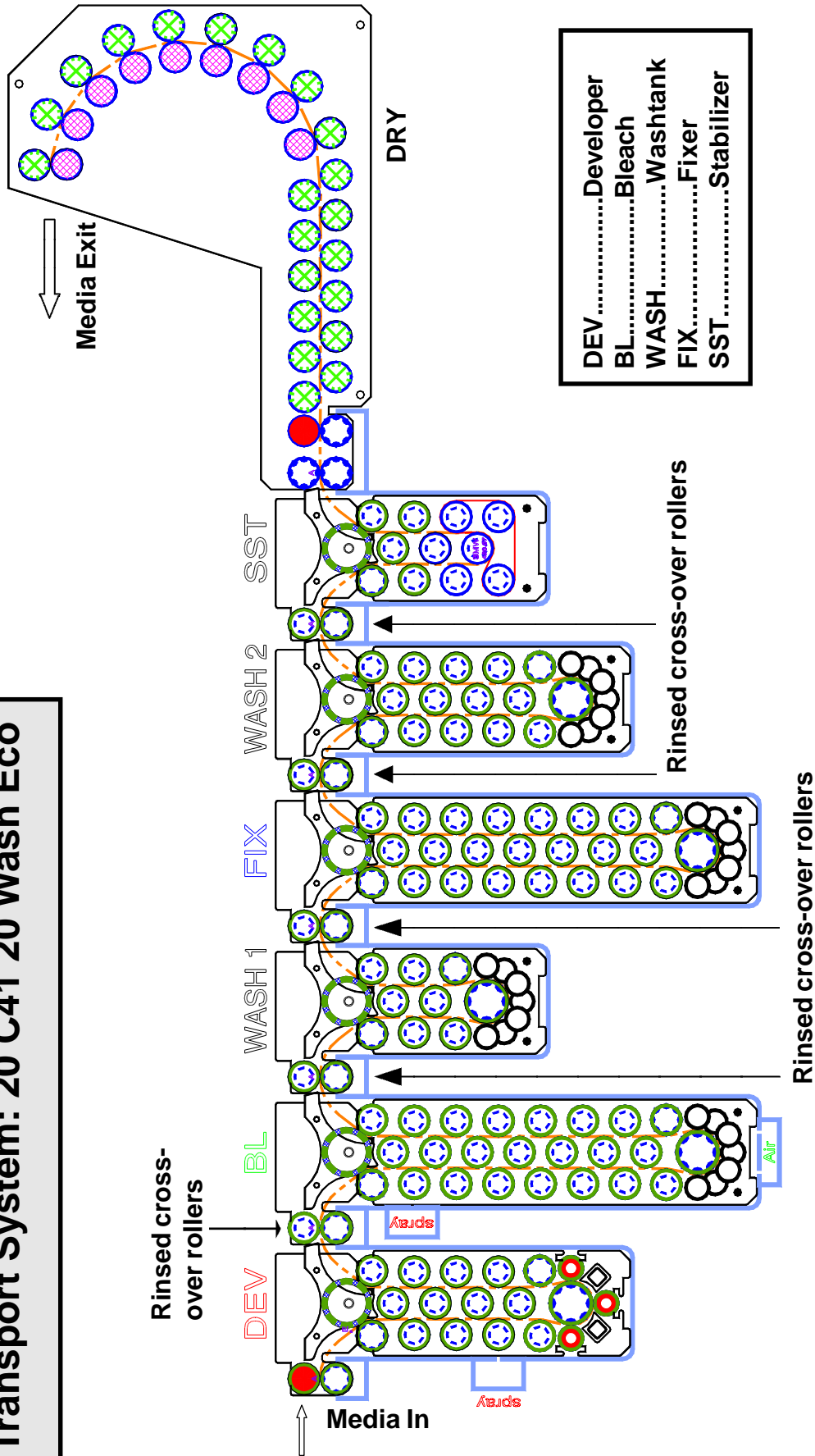

Dimensions: 20 C41 20 Wash Eco

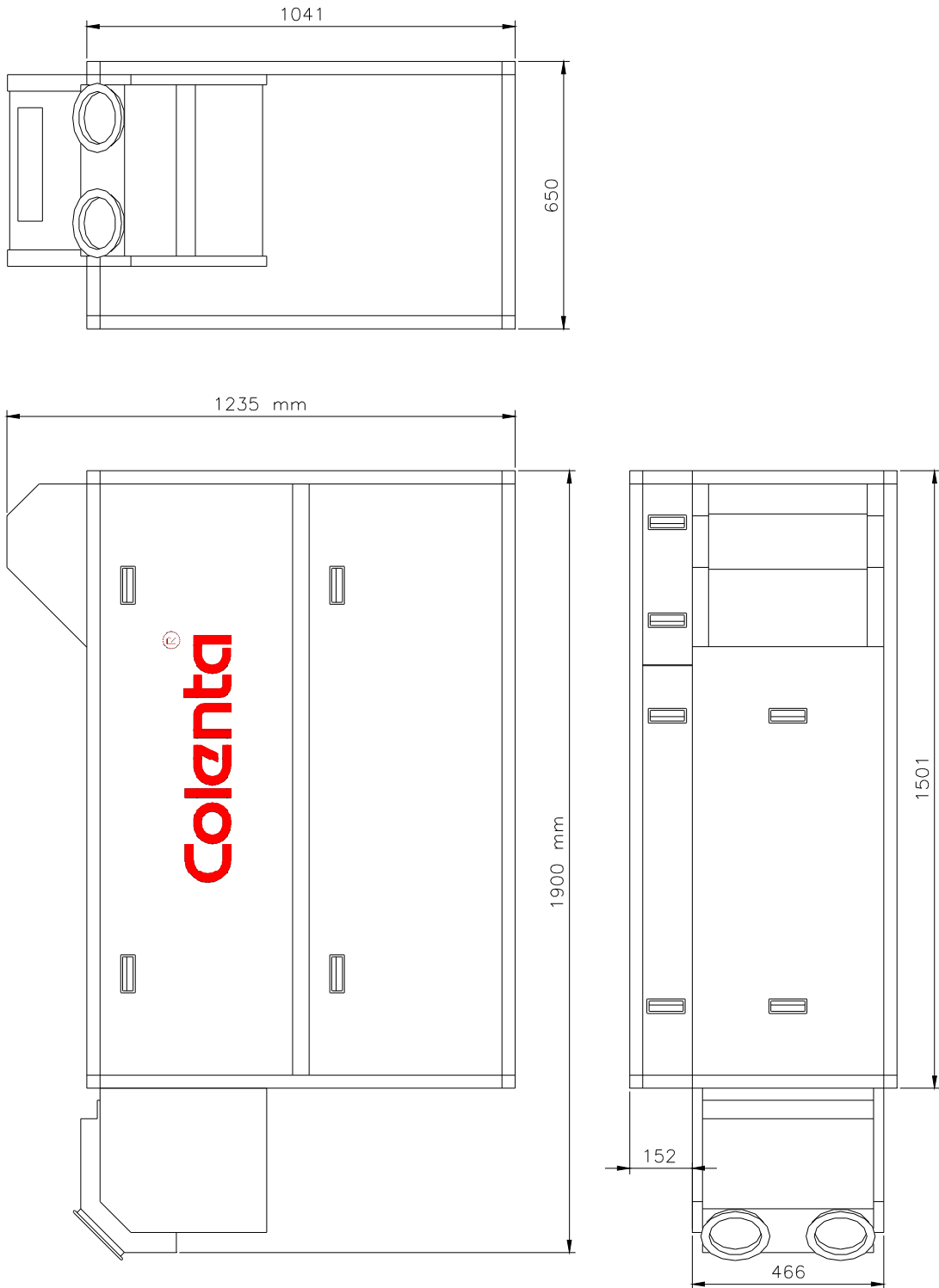

All dimensions are in mm.

We recommend a minimum walking space of 60cm around the processor.

through the wall installation : 20 C41 20 Wash Eco

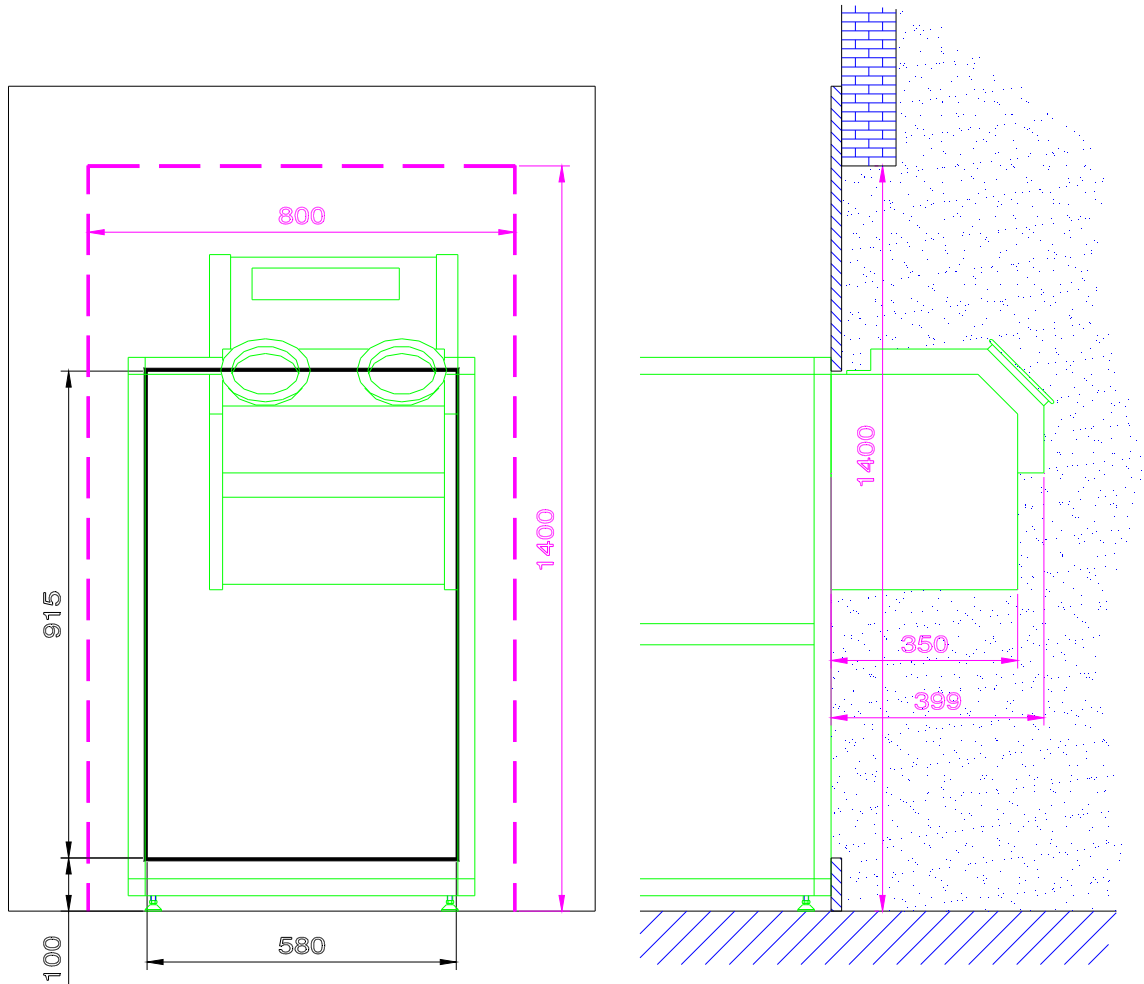

All dimensions are in mm.

We recommend a minimum walking space of 60cm around the processor.

Electrical supply: (Standard, when 3N~400/230V, 50/60 Hz supply available)

20 C41 20 Wash Eco

Colenta[®]

4,7 kW
13 A per phase

ATTENTION:
PROCESSOR TO BE CONNECTED TO
SUPPLY NET: 3N~380/220V 50/60Hz

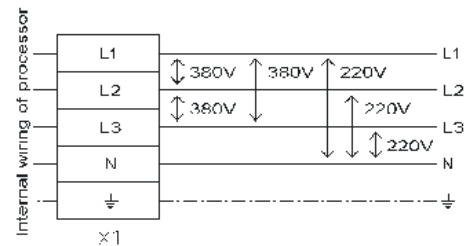

In case the above voltages are not available at site, please contact your local dealer or the factory for rewiring advice.

Alternatives, to be indicated when ordering

Details for shipment:

20 C41 20 Wash Eco

packing dimensions: 1 wooden box on palette
208cm x 82cm x 151cm (L x W x H)
packing volume: 2,57 m³
weight with packing: 363 kg